

### Premium Duty Spring Retractable Reels

**Air/Water/Oil/Grease** - 1/4", 3/8", 1/2" I.D.

Series 4000, 5000 and 5005 reels are all-steel construction and compact for a wide range of applications with critical space requirements. A full flow shaft and swivel assures maximum product delivery. Guide arm adjusts to two positions.



4625 OLP

5635 OLP

5650 OLP



**Enclosed Model**

5435 ELP

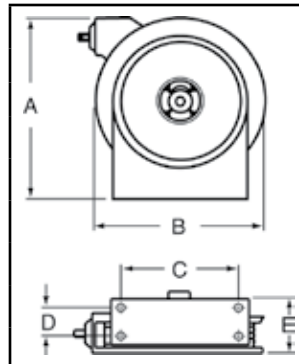

Dimensions - Size Index								
No.	1		2		3		4	
	in / mm		in / mm		in / mm		in / mm	
<b>A</b>	12 <sup>7</sup> / <sub>8</sub>	327	14 <sup>1</sup> / <sub>2</sub>	368	17 <sup>1</sup> / <sub>2</sub>	445	17 <sup>1</sup> / <sub>2</sub>	445
<b>B</b>	12 <sup>5</sup> / <sub>8</sub>	321	13 <sup>1</sup> / <sub>2</sub>	343	16 <sup>1</sup> / <sub>2</sub>	419	16 <sup>1</sup> / <sub>2</sub>	419
<b>C</b>	8	203	9 <sup>3</sup> / <sub>4</sub>	248	9 <sup>3</sup> / <sub>4</sub>	248	9 <sup>3</sup> / <sub>4</sub>	248
<b>D</b>	2 <sup>1</sup> / <sub>2</sub>	64	2 <sup>1</sup> / <sub>2</sub>	64	2 <sup>1</sup> / <sub>2</sub>	64	2 <sup>1</sup> / <sub>2</sub>	64
<b>E</b>	5 <sup>3</sup> / <sub>8</sub>	137	6	152	6	152	7	178

Four 5/16" (8mm) diameter mounting holes.

**Enclosed Models:** Series 5000 E reels are the same as 5000 O reels except E Series reels are fully enclosed. To order, change the model number suffix letter O to E, Example: 5430 OHP becomes 5430 EHP. Add 8 lbs. to open reel weight. Enclosed version is only available for Series 5000 reels (size index 2 reels). Refer to reelcraft.com for dimensional information.

Model with Hose	Shipping Weight lbs / kg	Pressure psi / bar	Hose I.D. in / mm	Hose O.D. in / mm	(M)NPTF Outlet in	(F)NPTF Inlet in	Hose Length ft / m	Model without hose & bumper	Shipping Weight lbs / kg	Pressure psi / bar	Size Index No.
<b>Low Pressure Air/Water Reels</b> Maximum Temperature 150° F (65° C)											
4420 OLP	18 8	300 21	1/4 6	.475 12	1/4	3/8	20 6	4400 OLP	17 8	500 35	1
4425 OLP	19 9	300 21	1/4 6	.475 12	1/4	3/8	25 8	4400 OLP	17 8	500 35	1
4435 OLP	19 9	300 21	1/4 6	.475 12	1/4	3/8	35 11	4400 OLP	17 8	500 35	1
5450 OLP	26 12	300 21	1/4 6	.475 12	1/4	3/8	50 15	5400 OLP	20 9	500 35	2
4617 OLP	19 9	300 21	3/8 10	.600 15	1/4	3/8	17 5	4600 OLP	17 8	500 35	1
4625 OLP	20 9	300 21	3/8 10	.600 15	1/4	3/8	25 8	4600 OLP	17 8	500 35	1
5635 OLP	25 11	300 21	3/8 10	.600 15	1/4	3/8	35 11	5600 OLP	21 10	500 35	2
5650 OLP	36 16	300 21	3/8 10	.600 15	1/4	3/8	50 15	5605 OLP	31 14	500 35	3
A5825 OLP	27 12	300 21	1/2 13	.750 19	1/2	3/8	25 8	A5800 OLP	22 10	500 35	2
A5835 OLP	39 18	300 21	1/2 13	.750 19	1/2	3/8	35 11	A5805 OLP	32 15	500 35	3
A5850 OLP	41 19	300 21	1/2 13	.750 19	1/2	3/8	50 15	A5806 OLP	35 16	500 35	4
<b>Medium Pressure Oil Reels</b> Maximum Temperature 210° F (99° C)											
5435 OMP	31 14	2750 190	1/4 6	.530 13	1/4	3/8	35 11	5400 OMP	23 10	3000 207	2
5630 OMP	31 14	2250 155	3/8 10	.710 18	3/8	3/8	30 9	5600 OMP	24 11	3000 207	2
A5825 OMP*	34 15	2000 138	1/2 13	.850 22	1/2	3/8	25 8	A5800 OMP	24 11	3000 207	2
A5835 OMP	42 19	2000 138	1/2 13	.850 22	1/2	3/8	35 11	A5805 OMP	32 15	3000 207	3
<b>High Pressure Grease Reels</b> Maximum Temperature 210° F (99° C)											
5430 OHP	30 14	5000 345	1/4 6	.580 15	1/4	1/4	30 9	5400 OHP	23 10	5000 345	2
5435 OHP	39 18	5000 345	1/4 6	.580 15	1/4	1/4	35 11	5405 OHP	33 15	5000 345	3
5625 OHP	32 15	4000 276	3/8 10	.730 19	1/4	1/4	25 8	5600 OHP	26 12	5000 345	2

Low pressure hose reels furnished standard with PVC hose. Compressed air hoses should not be converted to oxygen service - may cause explosion when O<sub>2</sub> mixes with fuel. Medium pressure reels furnished standard with S.A.E. 100 R1T one wire braid hose. **\*Floor tank mount only - do not mount on ceiling.** High pressure reels furnished standard with S.A.E. 100 R2T two wire braid hose, suitable for grease applications only.

<b>Available Options</b>	<b>Mounting Brackets</b> See page 47	<b>Inlet Hose Assemblies</b> See page 49	<b>Replacement Bumpers</b> See page 49	<b>Replacement Hoses</b> See page 50
--------------------------	---	---	---	---