

# AV4425 OLPBWL

## Air Vend Hose Reel

# New Product Announcement

### DESCRIPTION

The AV4425 OLPBWL from Reelcraft is designed for air service. The reel is our most compact design able to handle 25' of 1/4". It is small enough to be incorporated into air service stations or inside cabinets on trucks and comes from the factory constant tension without a latch pawl. It utilizes a "jump guard" to eliminate the possibility of hose jumping off the spool due to extremely violent return or operator error. It comes with a tougher one wire braid hose to resist abrasion and crushing.

### BENEFITS

- **Compact** Designed for tight spaces so that it may be mounted in cabinetry
- **Durable** Reel is made from heavy gauge industrial steel and hose is abrasion/crush resistant one wire braid.
- **Corrosion Resistant** Components are individually powder coated prior to assembly for a nearly impervious uniform finish.
- **Ease of Use** External guard eliminates the possibility of hose "jumping" off the spool during rewind.
- **Serviceable** External swivel design offers easy access to serviceable parts.



Model Shown:  
AV4425 OLPBWR

### RELATED PRODUCTS

Reelcraft offers a complete line of over 2,500 hose, cord and cable reels. For more information visit us on the web at [www.reelcraft.com](http://www.reelcraft.com).

### ACCESSORIES

ACCESSORY	DESCRIPTION	WEIGHT	
		lbs	kg
602366	Jump Guard 4000 Series	3	1.36
HR1145	Cabinet Roller Guide	.5	.23



Model Shown:  
AV4425 OLPBWL

### MODELS WITH HOSE

### HOSE CAPACITY

MODEL	WEIGHT		PRESSURE		I.D.		O.D.		(M)NPTF	(F)NPTF	LENGTH
	lbs	kg	psi	bar	in	mm	in	mm	OUTLET	INLET	
LOW PRESSURE REEL - Maximum Temperature 150°F (65°C)											
AV4425 OLPBWL	18	8	300	21	1/4	6	.530	14	1/4	3/8	25 8
AV4425 OLPBWR	18	8	300	21	1/4	6	.530	14	1/4	3/8	25 8

NOTE: reels come from factory in bottom wind position and are constant tension.

### DIMENSIONS

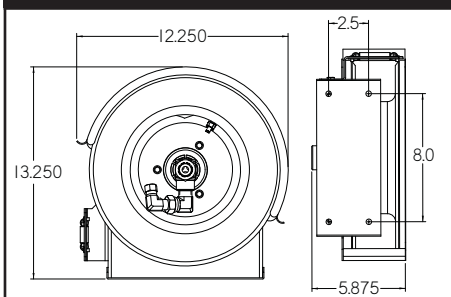

Four 5/16" (8mm) diameter mounting holes

### SPECIFICATIONS

- ✓ Inlet on either side: AV4425 OLPBWL (left) & AV4425 OLPBWR (right)
- ✓ S.A.E 100 R1T one wire braid hose with high quality crimpings and stop
- ✓ Protective hose "jump guard"
- ✓ Enhanced swivel is designed for more extreme applications
- ✓ Individual components receive a baked-on powder coat paint
- ✓ Nylon composite 4-way guide roller
- ✓ Made from industrial grade steel and engineered with gussets & structural forms
- ✓ Reels are constant tension (cabinet roller available as an accessory)

North America: 800-444-3134  
 Europe: +44 (0) 1536 406999  
 Pacific Rim: +63 (45) 625-6624  
 China: (519) 8512 2391  
 Latin America: 002-60-489-1685

### Reelcraft Industries, Inc.

2842 E. Business Highway 30  
 Columbia City, IN 46725  
 FAX: 260-248-2605

[www.reelcraft.com](http://www.reelcraft.com)

Reelcraft Industries is  
**ISO 9001:2000**  
 Certified Since 1996



Wind Things Up With Reelcraft™

AV4425 OLPBW / AIR VEND HOSE REEL